



The SFL offers the look of contemporary fluorescent lighting with the efficiency and low maintenance of LED technology. This series is ideal for use in offices, hospitals and schools

## SFL surface formed lens



### Features and Specifications:

#### Construction:

- Linear arrayed LED modules provide even illumination and are field replaceable
- Formed lens is retained in hinged door frame
- Made from code gauge steel

#### Size Options:

- Available in 2x2 or 2x4 sizes

#### Listing & Ratings:

- All electrical components are U.L. listed or recognized
- All fixtures are U.L. Certified and Union made in the USA
- Meets Buy America Act (BAA), BABA Compliant

#### Mounting Options:

- Surface or suspended mount

#### Driver:

- Universal voltage 120-277V standard
- Custom driver tuning available for specific lumen requirements
- 0-10V or Lutron dimming optional

#### Warranty:

- 5 years - part replacement only (see our terms & conditions page at [www.lamarled.com](http://www.lamarled.com) for details)

See page 2 for lumen chart & dimensions

Ordering Guide / Example

SFL22M-35

SFL				
Series	Lumens	Power	CCT	General Options
SFL = Surface formed lens	22 = 2x2 24 = 2x4	L = Low M = Medium H = High	30 = 3000K 35 = 3500K 40 = 4000K 50 = 5000K	EM = Emergency pack >90 min., >500 lumens (higher output & run time available - consult factory) EMB = BABA Compliant Emergency pack >90 min., >500 lumens D = 0-10V dimming to 1% DTD = 0-10V Dim to Dark LDH = Lutron EcoSystem Hi-lume digital 1% w/Fade to Black MX1 or MX2 = 2-wire 120V or 277V 5% phase cut dimming

Consult factory for additional options not shown or listed

Correlated Color Temperatures (CCTs) fall within the nominal range as per ANSI C78.377A

#### Project Information:

Job Name: \_\_\_\_\_ Fixture Type: \_\_\_\_\_

Catalog #: \_\_\_\_\_ Date: \_\_\_\_\_

Comments: \_\_\_\_\_

#### Certification & Listings:

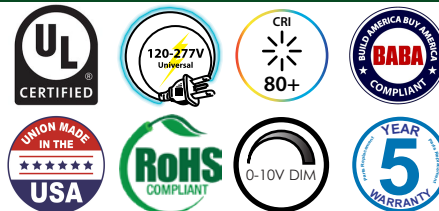

BEFORE INSTALLATION, PLEASE CONSULT YOUR LOCAL ORDINANCES AND BUILDING CODES FOR COMPLIANCE

Dimensions

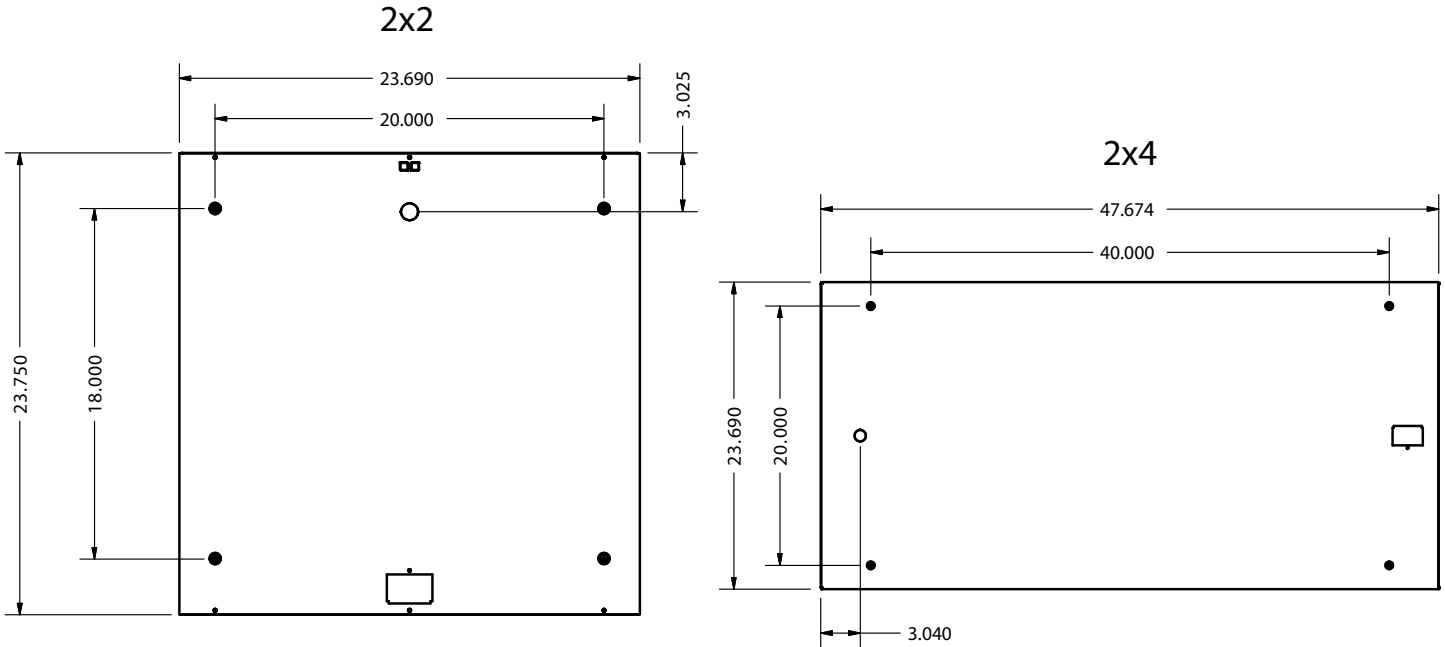

End View

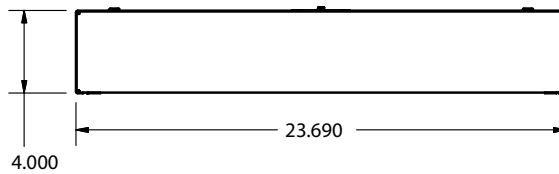

Lumen/Wattage Chart - 4000K

	Low	Medium	High
<b>2x2</b>	2340 Lu/21W	3230 Lu/30W	3986 Lu/38W
<b>2x4</b>	4680 Lu/42W	6459 Lu/59W	7972 Lu/75W